



YUHAI TECHNOLOGY & MANUFACTURING SUPPLIES PVT LTD

#Plot no 183/184 Ecotech - 1 Extension,
Kasna, Greater Noida-201310(UP), INDIA
Email : yuhaitech@gmail.com
Web: www.yuhai-tech.com
Contact: +91-9711074227 / 9650837069



YUHAI TECHNOLOGY & MANUFACTURING SUPPLIES PVT LTD

Professional Automatic Production line Solution Supplier
[Http://www.yuhai-tech.com](http://www.yuhai-tech.com)

Lean pipe series

Lean Pipe I mainly known for high efficiency, high degree of variability, simple, economic, environmental-friendly design concept. It is widely used in various industrial manufacturing fields.

It can make individual work-tables, and also the combination of many work-tables to make production conveyor lines.

Workshop equipments e.g. production line assemble stations, input material-tables, output material-tables, testing-tables and repair-tables etc.

Material Carts (General multi-layer material loading carts, the general material distribution carts, and temporary carts, specially designed carts for mobile and other manufacturing industries).

Traditional Racks with Multi-layer shelves can be made. It can also make advanced racks with FIFO system which are very light-weight. These racks can also use skate-rails that make the flow of materials very fast, make it efficient and cost-effective by reducing the manpower requirement.

Material Rack (Structures for the general materials placement, temporary frame structures).

Business applications (commodity display, personalized display shelf, creative display)

Other applications (white board frame, flower rack, items placed racks, shelves, and creative application)

Plastic resin

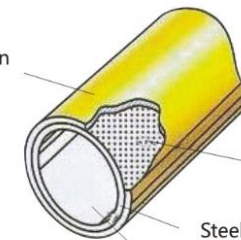

Adhesive

Steel pipe

Interior coating

Material	Steel tube with PE/ABS plastic layer
Type	●general●ESD●stainless steel
Color	White/beige/black/yellow/green/red/blue
Outside diameter	Φ28mm
Thickness	0.8mm , 1.0mm , 1.2m , It can be made according to customer's requirement
Specification	4000mm
Packing	10pcs/bundle

Company Introduction



YUHAI Technology & Manufacturing Supplies Pvt Ltd was established on 22nd Feb. 2017 all promoters of YUHAI have an extensive experience of more than 15 years in the field of "Static Electricity & ESD Control". Having served the industry with full commitment, we have developed ourselves as manufacturers and service providers of Production Lines. We are specialized in designing & Manufacturing of various types of Working Tables, Assembly Lines & Conveyor Lines etc. We provide various solutions for Lean Production, Material Handling, Material Storage, Logistics and Distribution etc.

We can design & Manufacture customized systems that are in accordance to the customers' requirements. Our products are widely used in Electronics, Automobile, Food-Processing, Pharmaceutical, Logistics & Courier, and Toys and have very good reputation among our customers.

We follow our policy of "Guided by Customers Requirement with the intent of Refinement & Innovation". We focus on our products to help customers building intelligent factories and improve their core competitiveness.



YOUR TRUSTED SUPPLY SOURCE



PE Lean pipe

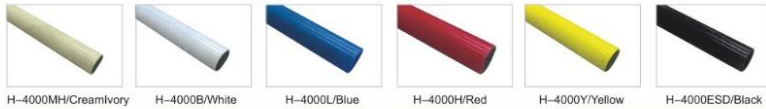

Lean pipe stainless steel



H series electrophoresis monolithic joint /Powder coated joints



H series chromium coating joint



X Fluent joints /Joints for skate-rails



Plastic accessories series



Castor series



Foot cup series



Other accessories



HJ metal joint series

Chromate plate white metal joins come under "D" category
 Black colored Powder coated metal joins come under "P" category



No. : HJ-1P/HJ-1D
 Form : H-1P/D*2pcs+M6-25*1pcs



No. : HJ-2P/HJ-2D
 Form : H-2P/D+H-3P/D*2pcs+M6-25*2pcs



No. : HJ-3P/HJ-3D
 Form : H-2P/D*2+H-4P/D*2pcs+M6-25*3pcs

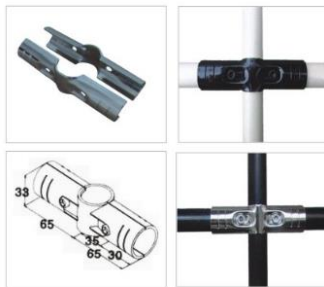

No. : HJ-4P/HJ-4D
 Form : H-4P/D*2+M6-25*2pcs

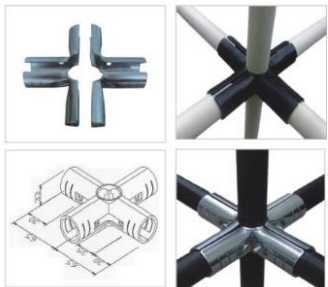

No. : HJ-5P/HJ-5D
 Form : H-2P/D*4+M6-25*4pcs

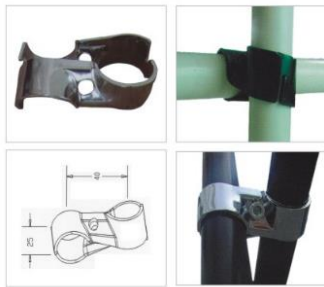

No. : HJ-6P/HJ-6D
 Form : H-7P/D*2+M6-25*1pcs

HJ metals joint series

Chromate plate white metal joins come under "D" category
 Black colored Powder coated metal joins come under "P" category



No. : HJ-7P/HJ-7D
 Form : (H-5P/D+H-6P/D)*2+M6-25*2pcs



No. : HJ-8P/HJ-8D
 Form : H-9P/D*2+M6-25*1pcs+ 塑料内套 *2pcs

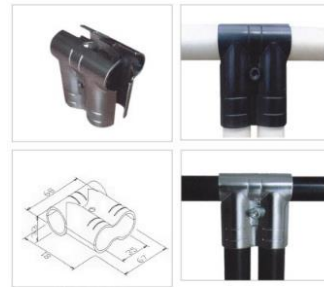

No. : HJ-9P/HJ-9D
 Form : H-10P/D*2+M6-25*1pcs



No. : HJ-10P/HJ-10D
 Form : H-12AP/D+H-12BP/D+M6-25*1pcs+ 塑料内套 *1pcs



No. : HJ-11P/HJ-11
 Form : H-13P/D*2+M6-25*1pcs

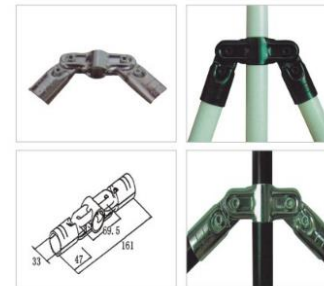

No. : HJ-12P/HJ-12D
 Form : H-6P/D*4+H-14P/D*2+M6-25*4pcs



Tote cart and trolley/special worktable series



Industrial aluminum alloy series

20*20 Round hole Aluminium LC-1001	80*40 Aluminium LC-1002
 <p>Material : Aluminium(6063-T5) Weight : 0.65KG/m Length : 6.00m Mass of inertia : $lx0.72cm^4, ly0.72cm^4$ Section modulus : $Zx0.72cm^3, Zx0.72cm^3$</p>	 <p>Material : Aluminium(6063-T5) Weight : 1.05KG/m Length : 6.00m Mass of inertia : $lx2.85cm^4, ly2.85cm^4$ Section modulus : $Zx1.80cm^3, Zx1.80cm^3$</p>
30*30 Round hole Aluminium LC-1003	40*40 Quincunx square Aluminium LC-1004
 <p>Material : Aluminium(6063-T5) Weight : 1.05KG/m Length : 6.00m Mass of inertia : $lx2.85cm^4, ly2.85cm^4$ Section modulus : $Zx1.80cm^3, Zx1.80cm^3$</p>	 <p>Material : Aluminium(6063-T5) Weight : 1.35KG/m Length : 6.00m Mass of inertia : $lx9.70cm^4, ly9.70cm^4$ Section modulus : $Zx1.80cm^3, Zx1.80cm^3$</p>
40*40 Round edge square hole Aluminium LC-1005	40*40 Round edge round hole Aluminium LC-1006
 <p>Material : Aluminium(6063-T5) Weight : 1.55KG/m Length : 6.00m Mass of inertia : $lx9.25cm^4, ly9.25cm^4$ Section modulus : $Zx4.86cm^3, Zx4.86cm^3$</p>	 <p>Material : Aluminium(6063-T5) Weight : 2.20KG/m Length : 6.00m Mass of inertia : $lx10.20cm^4, ly10.20cm^4$ Section modulus : $Zx5.32cm^3, Zx5.32cm^3$</p>
40*40 Round hole Aluminium LC-1007	40*40 Round hole in middle Aluminium LC-1008
 <p>Material : Aluminium(6063-T5) Weight : 2.40KG/m Length : 6.00m Mass of inertia : $lx9.70cm^4, ly9.70cm^4$ Section modulus : $Zx5.10cm^3, Zx5.10cm^3$</p>	 <p>Material : Aluminium(6063-T5) Weight : 1.65KG/m Length : 6.00m Mass of inertia : $lx9.70cm^4, ly9.70cm^4$ Section modulus : $Zx5.10cm^3, Zx5.10cm^3$</p>



Industrial aluminum alloy series

Corner Fittings:

Corner Fittings are used at the joining points of two sections and provide enough strength to the structure so it withstands for longer time. A correctly angled corner joint also helps maintaining a right position between two sections fitted with T-bolts and nuts and this position can also be adjusted by these corner joints.



Special bolt head bolts

Slot width

LF8*40

LF8*60

LF8*80

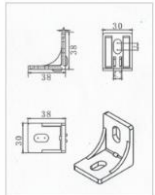

Aluminum corner connector 1

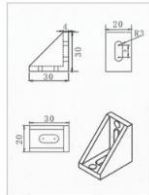

Aluminum corner connector 2

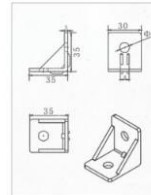

Aluminum corner connector 3

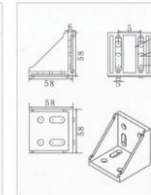

Aluminum corner connector 4

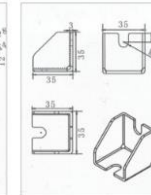

Aluminum corner connector 5

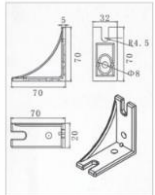

Aluminum corner connector 6

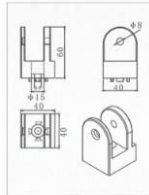

Aluminum corner connector 7

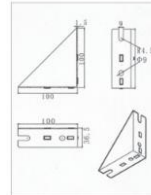

Aluminum corner connector 8

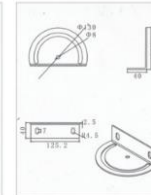

Aluminum corner connector 9

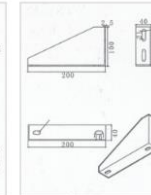

Aluminum corner connector 10



Aluminum cover

Specifications are commonly used
2020, 2040, 3030, 3060, 4040, 4060,
4080, 4590, 4545, 5050, 6060, 8080,
9090



Aluminum sealing bar

Usage:
surface trough from profiles into
Color:
black, yellow, white, green, blue, gray
Size : 12mm, 8mm, 6mm

Aluminum workbench/Special worktable series





Third generation lean pipe & parts

Third Generation Lean Pipe:

The Third Generation Lean Pipe, made of silver colour aluminium, has its surface treated by anodic oxidation and so is permanently rust-proof. All connectors and fasteners for these pipes have been improved a lot and are now very advanced. They are made by pressure casting aluminium which is harder and stronger.

Special Features:

- 1) Easy to assemble
- 2) Elegant appearance
- 3) Environmental-friendly
- 4) Diameter 28mm cross-symmetry dovetail groove structure

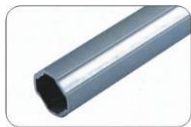
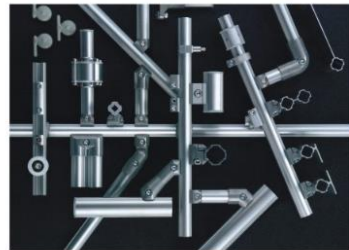
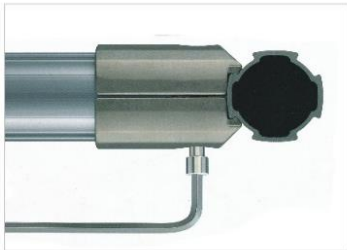

Name: Aluminium tube
 P/N: T3-AL2812/T3-AL2817
 Material: 6063-T5(surface oxidation spray with white sand)
 Standard length: 4m/pcs
 Weight: 0.38kg/m (T=1.2mm)
 0.42kg/m (T=1.7mm)

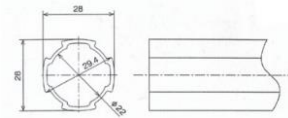

Name: Aluminium tube(big)
 Material: 6063-T5 (Surface oxidation spray with white sand)
 P/N: T3-AL4319
 Standard length: 4m/pcs
 Weight: 0.72kg/m
 Thickness: 1.9mm

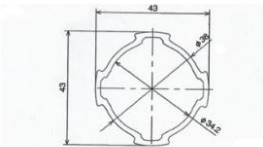

Third generation lean pipe & parts



Name: Straight connector
 Material: Aluminium+ADC-12
 P/N:SL-28-01

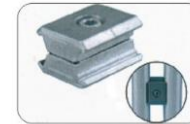

Name: Parallel connector
 Material: Aluminium+ADC-12
 P/N:SL-28-06



Name: Parallel connector
 Material: Aluminium+ADC-12
 P/N:SL-28-11



Name: 90° curve connector
 Material: Aluminium+ADC-12
 P/N:SL-28-02

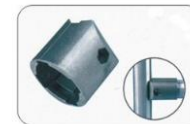

Name: T shape connector
 Material: Aluminium+ADC-12
 P/N:SL-28-07



Name:90° degree curve connector
 Material: Aluminium+ADC-12
 P/N:SL-28-12



Name: 45° curve connector
 Material: Aluminium+ADC-12
 P/N:SL-28-03



Name: Cross connector
 Material: Aluminium+ADC-12
 P/N:SL-28-08



Name: 45° degree curve connector
 Material: Aluminium+ADC-12
 P/N:SL-28-13



Name: Diagonal brace connector
 Material: Aluminium+ADC-12
 P/N:SL-28-04



Name: Twin connector
 Material: Aluminium+ADC-12
 P/N:SL-28-09



Name: Link connector
 Material: zinc alloy
 P/N:SL-28-14



Name: Rotate connector
 Material: Aluminium+ADC-12
 P/N:SL-28-05



Name: Rotate connector
 Material: Aluminium+ADC-12
 P/N:SL-28-10



Name: Set connector
 Material: Aluminium+ADC-12
 P/N:SL-28-15



Third generation lean pipe & parts

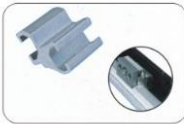

Name: table clamps
Material: Aluminium+ADC-12
P/N:SL-28-16



Name: swell footstand
Material: zinc alloy
P/N:SL-28-21



Name: Baffle ring
Material: Aluminium+ADC-12
P/N:SL-43-02

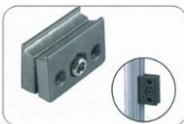

Name: Parallel connector
Material: Zinc alloy
P/N:SL-28-17



Name: Rubber footstand
Material: Rubber
P/N:SL-28-22



Name: External direct connector
Material: Aluminium+ADC-12
P/N:SL-43-03



Name: U shape connector
Material: Aluminium+ADC-12
P/N:SL-28-1

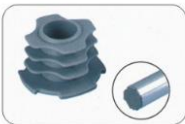

Name: Top cover
Material: LDPE
P/N:SL-28-23



Name: 90° external curve connector
Material: Aluminium+ADC-12
P/N:SL-43-04



Name: Wheel base
Material: Aluminium+ADC-12
P/N:SL-28-19



Name: Translation part
Material: Aluminium+ADC-12
P/N:SL-43-01



Name: Big top cover
Material: LDPE
P/N:SL-43-05



Name: Aluminium tube connector
Material: Aluminium+ADC-12
P/N:SL-28-20



Name: Rotate part
Material: Aluminium+ADC-12
P/N:SL-43-01A



Name: Footstand
Material: Q235+Galvanization
P/N:SL-43-06

Aluminium slide way series

Slide Way (Skate-rail) is used to make transportation carts & storage carts e.g. FIFO racks. It is very easy to install on the carts and makes the carts highly efficient in terms of materials movement. Aluminium Slide-way is constructed by aluminium alloy frame-work, ABS wheels, ABS separation bar, steel roller shaft and the cover plate at both ends.

Special Features:

- 1) Small Friction Coefficient
- 2) Smart Looking
- 3) Very Strong
- 4) Shock Resistant
- 5) Long Service Life

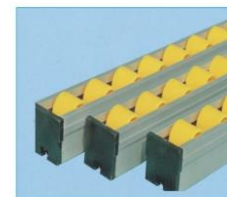

Aluminium slide way SQ-41A
Aluminium framework (W*H): 41mm* 35mm
Total height(include wheel): 38.5mm
ABS roller : φ28*25mm
Roller shaft : 45# Galvanization steel
Distance of roller shaft : 30mm,45mm,60mm
Quantity : 33pcs , 22pcs , 16pcs/meter
Workload of single roller shaft : 10kg
Workload of each meter : 100kg

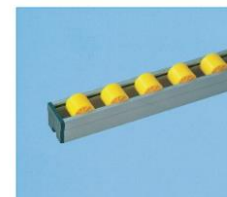

Aluminium slide way SQ-41B
Aluminium framework (W*H): 41mm* 35mm
Total height(include wheel): 42.5mm
ABS roller : φ28*25mm
Roller shaft : 45# Galvanization steel
Distance of roller shaft : 30mm,45mm,60mm
Quantity : 33pcs , 22pcs , 16pcs/meter
Workload of single roller shaft : 10kg
Workload of each meter : 100kg

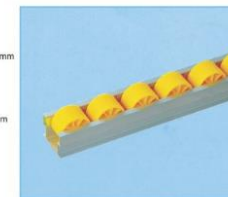

Aluminium slide way SQ-44A
Aluminium framework (W*H): 44mm* 33mm
Total height(include wheel): 40mm
ABS roller : φ38*25mm
Roller shaft : 45# Galvanization steel
Distance of roller shaft : 45mm
Quantity : 22pcs/meter
Workload of single roller shaft : 20kg
Workload of each meter : 80kg



Aluminium slide way SQ-41A
Aluminium framework (W*H): 41mm* 35mm
Total height(include wheel): 38.5mm
ABS roller : φ38* 28*25mm
Roller shaft : 45# Galvanization steel
Distance of roller shaft : 45mm , 60mm
Quantity : 22pcs,16pcs/meter
Workload of single roller shaft : 10kg
Workload of each meter : 100kg

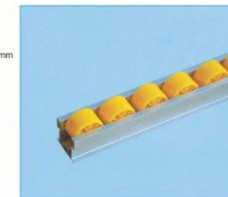

Aluminium slide way SQ-44B
Aluminium framework (W*H): 44mm* 38mm
Total height(include wheel): 48mm
ABS roller : φ38*25mm
Roller shaft : 45# Galvanization steel
Distance of roller shaft : 45mm
Quantity : 22pcs/meter
Workload of single roller shaft : 20kg
Workload of each meter : 80kg

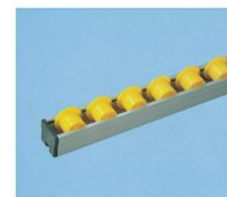

Aluminium slide way SQ-41B
Aluminium framework (W*H): 41mm* 35mm
Total height(include wheel): 42.5mm
ABS roller : φ38* 28*25mm
Roller shaft : 45# Galvanization steel
Distance of roller shaft : 45mm , 60mm
Quantity : 22pcs,16pcs/meter
Workload of single roller shaft : 10kg
Workload of each meter : 100kg



Aluminium slide way SQ-38
Aluminium framework (W*H): 30mm*22mm
Total height(include wheel): 24mm
ABS roller : φ13*14mm
Roller shaft : 45# Galvanization steel
Distance of roller shaft : 15mm,30mm
Quantity : 66pcs,23pcs/meter
Workload of single roller shaft : 4kg
Workload of each meter : 80kg



Metal plate slide way series

Metal plate slide way is made by galvanization steel go through automatic punching line, precise numerical control Cold formed steel rolling production to form a U shape framework. Assembly with ABS roller and steel roller shaft.

Special Feature:

- 1) Sustain Heavy Load
- 2) Complete Size
- 3) Wild Range Application
- 4) Easy to assemble
- 5) Low cost
- 6) Very strong

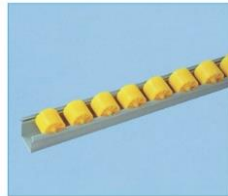

Metal plate slide way SQ-40
 Galvanization steel framework (W*H): 41mm*26mm
 Total height include wheel: 38mm
 Thickness of galvanization steel: 0.8mm, 1.2mm
 ABS roller: φ28*25mm
 Roller shaft: 45# Galvanization steel
 Distance of roller shaft: 35mm 45mm
 Quantity: 28pcs, 22pcs/meter
 Workload of single roller shaft: 6kg
 Workload of each meter: 80kg

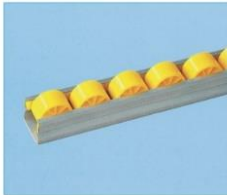

Metal plate slide way SQ-44
 Framework (W*H): 44mm*33mm
 Total height include wheel: 44mm
 Thickness of galvanization steel: 0.8mm, 1.2mm
 ABS roller: φ38*25mm
 Roller shaft: 45# Galvanization steel
 Distance of roller shaft: 45mm
 Quantity: 22pcs/meter
 Workload of single roller shaft: 20kg
 Workload of each meter: 80kg



40 Metal plate slide way SQ-48
 Framework (W*H): 40mm*33mm
 Total height include wheel: 45mm
 Thickness of galvanization steel: 0.8mm, 1.2mm
 ABS roller: φ32*22.5mm
 Roller shaft: 45# Galvanization steel
 Distance of roller shaft: 36mm
 Quantity: 28pcs/meter
 Workload of single roller shaft: 10kg
 Workload of each meter: 100kg



40 Metal plate slide way SQ-48
 Framework (W*H): 40mm*33mm
 Total height include wheel: 47mm
 Thickness of galvanization steel: 0.8mm, 1.2mm
 ABS roller: φ38*22.5mm
 Roller shaft: 45# Galvanization steel
 Distance of roller shaft: 45mm
 Quantity: 22pcs/meter
 Workload of single roller shaft: 10kg
 Workload of each meter: 100kg



60 Metal plate slide way SQ-48
 Framework (W*H): 60mm*33mm
 Total height include wheel: 44mm
 Thickness of galvanization steel: 0.8mm, 1.2mm
 ABS roller: φ30*42mm
 Roller shaft: 45# Galvanization steel
 Distance of roller shaft: 36mm
 Quantity: 28pcs/meter
 Workload of single roller shaft: 30kg
 Workload of each meter: 300kg

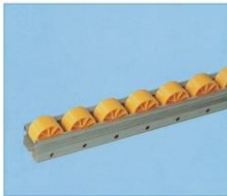

60 Metal plate slide way SQ-8
 Framework (W*H): 60mm*25mm
 Total height include wheel: 30mm
 Thickness of galvanization steel: 0.8mm, 1.2mm
 ABS roller: φ15*42mm
 Roller shaft: 45# Galvanization steel
 Distance of roller shaft: 16mm
 Quantity: 62pcs/meter
 Workload of single roller shaft: 20kg
 Workload of each meter: 20kg



85 Metal plate slide way
 Framework (W*H): 85mm*33mm
 Total height include wheel: 50mm
 Thickness of galvanization steel: 0.8mm, 1.2mm
 ABS roller: φ45*55mm
 Roller shaft: 45# Galvanization steel
 Distance of roller shaft: 50mm
 Quantity: 20pcs/meter
 Workload of single roller shaft: 60kg
 Workload of each meter: 800kg

Lean pipe production line application



Electronic manufacturing



Electronic assembly



Home appliance industry

Lean pipe production line application

Lean pipe production line application



Automotive industry



Automated guided vehicle



Mobile manufacturing



Storage applications



Battery manufacturing



Logistic purpose

Lean pipe production line application



Pharmaceutical industry



Food processing



Testing/lab applications

PCB storage series /Magazine racks



YH-06A-02



YH-06A-03



YH-06A-06



YH-06A-08LG

P/N	Resistance	Size	PCB Quantity	PCB size	Adjust method	Note
YH-06A-02	10 ⁻¹ -10 ¹ Ω	355*315*580mm	50pcs	355* (80*250) mm	Screw	Groove depth 4.3mm, Groove Depth 7mm Groove distance 10mm
YH-06A-03	10 ⁻¹ -10 ¹ Ω	355*320*563mm	50pcs	355* (30*250) mm	Gear	Groove depth 3mm, Groove Depth 5.5mm Groove distance 10mm
YH-06A-06	10 ⁻¹ -10 ¹ Ω	460*400*563mm	50pcs	460* (35*330) mm	Gear	Groove depth 4mm, Groove Depth 5.5mm Groove distance 10mm
YH-06A-08LG	Conductive	535*460*570mm	50pcs	535* (50*390) mm	Screw	Groove depth 4mm, Groove Depth 8mm Groove distance 10mm high temperature proof 500°C

Anti-static PCB carts /Trolleys



YH-C101A



YH-C102A



YH-C104B

P/N	Resistance	Size	PCB Quantity	Loading way	Note
YH-C101A	10 ⁻¹ -10 ¹ Ω	720*614*1650mm	160pcs	Vertical	5" ESD wheel 2 pcs, 5" ESD Omni-directional wheel(with brake) 2 pcs
YH-C102A	10 ⁻¹ -10 ¹ Ω	1010*650*1400mm	720pcs	Vertical	4" ESD wheel 2 pcs, 4" ESD Omni-directional wheel(with brake) 2 pcs
YH-C104B	10 ⁻¹ -10 ¹ Ω	1000*450*1200mm	400pcs	Horizontal	4" ESD wheel 2 pcs, 4" ESD Omni-directional wheel(with brake) 2 pcs



Anti-static chairs & Stools



YH-9201



YH-9211



YH-9221



YH-9231



YH-9241



YH-9251



YH-9261



YH-9271

Item	Resistance	Lifting method	Adjustable high	Chair surface material
YH-9201	10 ⁶ -10 ⁹ Ω	Gas lift	420-560mm	ESD leather
YH-9211	10 ⁶ -10 ⁹ Ω	Gas lift	420-560mm	PU
YH-9221	10 ⁴ -10 ⁹ Ω	Gas lift	400-540mm	Plastic
YH-9231	10 ⁴ -10 ⁹ Ω	Fixationt	450mm	Plastic
YH-9241	10 ⁶ -10 ⁹ Ω	Gas lift	420-560mm	ESD leather
YH-9251	10 ⁶ -10 ⁹ Ω	Gas lift	380-520mm	PU
YH-9261	10 ⁴ -10 ⁹ Ω	Gas lift	420-560mm	Plastic
YH-9271	10 ⁴ -10 ⁹ Ω	Fixationt	450mm	Plastic

Dissipative dual layer rubber mats

Size W(m)*L(m)*T(mm)	Color	Surface treatment	Top layer resistance	Bottom layer resistance
0.6*1.0*2	Green/black	Dull/Shiny	10 ⁶ -10 ⁹ Ω	10 ⁴ -10 ⁹ Ω
0.9*1.0*2	Green/black			
1.0*1.0*2	Green/black			
1.2*1.0*2	Green/black			

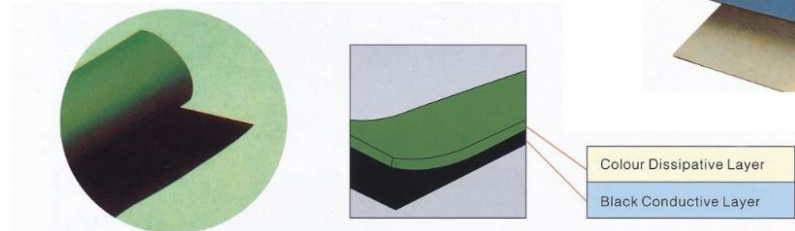

Dual Layer Table Mat is designed to eliminate Electro-static charges from personnel, tote boxes, bags, components etc. It is flat and not curled and is not affected by humidity. It has superior resistance to abrasion, chemicals and heat and is easy to clean & maintain.

Anti-static anti-fatigue floor mat

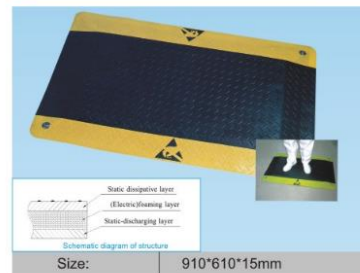

Material : Surface layer made of PVC ,medium layer made of EPDM

Using process/site
Used inn partial areas in both anti-static and non anti-static environments where several working tables or conveyor lines are in place.
Suitable for re-construction of anti-static area (especially floor), it is an economic and affective anti-static measure.
Suitable for use in long-time standing job positions.

Anti-static curtain

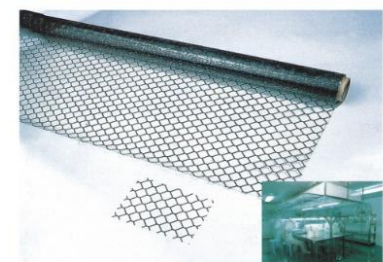

Resistant to fire,block off static and ultraviol

Size: 1.37m*30m*0.3mm
1.37m*25m*0.3mm
Material: PVC
Feature:
dim surface 10⁷-10⁸Ω grid surface 10⁴-10⁹Ω
Using process/site :
Prevent static, used in no-dust room.



Sole cleaning machine

YUHAI sole cleaning Machine uses an advanced brush technique and has water-recycle system. It cleans the dust from shoe sole very quickly when the personnel walk through the machine. It is very effective, efficient and so suitable for clean-room applications. It is a very sturdy system and works for long time. It can be installed at every entrance so it restricts the dust entry and protects shop-floor environment. YUHAI sole-cleaning machine is suitable for Automobile, electronics, Pharmaceuticals medicines, food-processing industries and all other clean-room applications. We can customize these machines according to customer's requirements also.

Special Features:

- 1.) Intelligent Work
- 2.) Automatic Sensors
- 3.) Energy Saving
- 4.) Customized Designs



tailor-make carbon fiber compounded wool

360° no dead corner intelligent interaction

super water-absorbing foam

Technical Data

Part NO.	YH-W100	YH-W180	YH-W300
Size(mm)	1000*750*(135-145)	1800*750*(135-145)	3000*750*(135-145)
Cleaning area size(mm)	370*520	900*520	1700*520
Drying area size(mm)	360*510	640*510	1030*510
Entry water temperature(°C)	0-40	0-40	0-40
Volume(L)	30	30	30
Voltage	AC220V 50HZ	AC220V 50HZ	AC220V 50HZ
Power of Motor	180W	180W	180W
Power of pump	100W	100W	100W
Current	1.5A	1.5A	1.5A
Safety protection	short circuit/overload	short circuit/overload	short circuit/overload
Noise Volume	< 60db	< 60db	< 60db
Maximum load	400kg	400kg	400kg
Stainless steel handrail	optional	optional	optional

ESD access control system



Item	Description
Gate	304# stainless steel case, Machine core, Control board, Led Module
Power	AC220V input; DC24V, DC12V output(inside)
Driving method	Solenoid valve/motor
Direction	One way/double way (can be chosen)
Size	1200mm(length)*280mm(width)*980mm(height)
Pass width	500-600mm
Gate period	0.25(not include test time) 2s-5s(include test time)
signal	LED pass light
working environment	inside, outside(suggest cover)
working temperature	-10°C~60°C, relative humidity5%-95%
Life time	10 years
weight	65kg
data interface	RS485 or RS232
control interface	TTL level signal or relay switch signal
OS	Chinese OS
Range	Test wrist range : 750KΩ-10MΩ Test ESD shoes range : 100KΩ-100MΩ(adjusted)

Dual footwear/wrist strap tester



Can test the ESD wrist strap and ESD shoes's anti static function
Test wrist Range:750KΩ - 10MΩ
Test ESD shoes Range:100KΩ - 100MΩ

Ground system line monitor



Continuous monitor of one or two wrist straps. Manual or auto switch on available. Automatic alarm function.

Surface resistance tester



This tester can test the conductive, dissipative and insulate surface resistance.
Range: 10¹-10¹⁰Ω
Tolerance ±10%

Electrostatic ionizing air blowers



Quickly neutralizes the static charge. Suitable for electronics manufacturing & other applications (e.g. Mobile Manufacturing); fast static removal time and stable ion-balance.
Discharge time: <1s
Ion balance: 0±10V



Human body grounding system



Dual coiled cord metal wrist strap



Single coiled cord metal wrist strap



Elastic wrist strap



Ground lead kit



Fabric: 5mm stripe, 5mm/2.5mm grid, different colors available

ESD/cleanroom garment fabric



Anti-static lab coat



Anti-static jacket and pants



Anti-static jump suit



PU Anti-static boot



PVC Anti-static butterfly shoes



SPU Anti-static slipper



Anti-static safe shoes



PU coated glove



PU top fit textured glove



PU palm textured glove



Anti-static finger coat

Cleanroom consumables series



Clean foam swab
Clean polyester swab
Clean cotton swab



Microfiber cleanroom wipers
Polyester cleanroom wipers



SMT roller wipers



Sticky mats

This catalogue is only for production line, we also supply anti-static and cleanroom products which are not included in this catalogue, please visit or call us for more information.